

**UniMac**

Maximum Performance



**MAXIMUM BALANCE OF RESOURCES.  
SERIOUS RESULTS.**

UNIMAC.COM

**UC SERIES HARDMOUNT WASHER-EXTRACTORS 20-80 LB**

# UC SERIES HARDMOUNT 20-80 LB WASHER-EXTRACTORS

As the leading manufacturer of on-premises laundry equipment, UniMac® offers more than 7 decades of incomparable quality and long-lasting performance. Our UC series is built with unyielding construction to ensure industrial strength. Our cutting-edge innovations and technologies reduce costs and maximize throughput. And we're constantly improving. It's all part of our commitment to providing the lowest cost of ownership in the industry.



## LOWER YOUR COSTS WITH UNIMAC

- Faster extraction technology spins up to 200 G-Force to remove more water during each load, resulting in shorter drying times and lower energy bills.
- The proven technology and proprietary design of our advanced inverter drive provides smooth, reliable power for optimal wash and extract performance.
- Uses 7% less water, while maintaining optimal cleaning.
- Water Guardian leak detection leak detection reduces water consumption by detecting leaking fill or drain valves, identifying leaks before they cost your operation hundreds of dollars in wasted resources.



## OUR COMMITMENT TO ON-PREMISES LAUNDRY

Our customers are the direct focus of every product we manufacture and every decision we make. We make sure every piece of UniMac equipment comes with peace of mind and the support you need to help your business succeed. We are with you every step of the way with:

- Support from a worldwide network of distributors and a team of trained technicians.
- Service-parts availability.
- Service-training certification for distributors through Alliance Laundry Systems University.

## INDUSTRY-LEADING DURABILITY

The washer-extractor's heavy-duty, robotically welded frame is designed to stand up to the toughest laundry conditions. It's stronger than ever before, has a quieter operation and balances loads more efficiently.

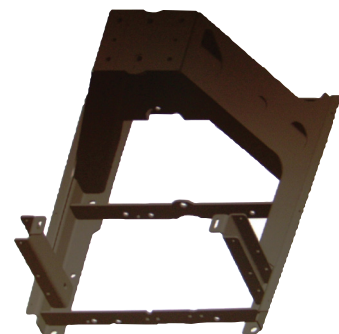

## BEST-IN-CLASS BEARING PROTECTION

UniMac washer-extractors feature two close-tolerance ball bearings, permanently lubricated for trouble-free operation. Excluder seal and two triple-lip seals provide seven times the sealing power to isolate the bearings from water and chemicals.



## M9 CONTROL

Offers nine cycles that can be modified to meet your laundry's unique demands. Three water levels and up to five supply signals for automated dispensing of laundry chemicals. Cycle counter and test cycle for self-diagnostics.



Proudly based in Ripon, Wisconsin, USA, UniMac is dedicated to research, development and testing to provide equipment that delivers industrial strength and long-lasting quality. Our products undergo a 5-stage product-development process and are pushed beyond their limits in our state-of-the-art test lab to ensure they exceed the toughest demands of the commercial environment and meet our customers' highest standards.



## UC SERIES AT A GLANCE

- Improved cycle times
- Reduced drying time and increased throughput with up to 200 G-Force extraction speed
- Computer-optimized frame design stronger than ever before, with quieter operation
- Stainless-steel top and front panels
- Offered in five capacity options (20, 30, 40, 60 and 80 lb)
- Heavy-duty bearings and seals
- Engineered for quick troubleshooting and ease of service
- Self-cleaning, four-compartment dispenser
- Large, heavy-duty loading door
- Faster fill times – UC60 43%, UC80 20%



# UC SERIES HARDMOUNT WASHER-EXTRACTORS 20-80 LB

SPECIFICATIONS		UCT20	UCT30	UCT40	UCT60	UCT80
Control Option		M9	M9	M9	M9	M9
Capacity - lb (kg)		20 (9)	30 (13.6)	40 (18)	60 (27)	80 (36)
Overall Width - in (mm)		26 (660)	29 (737)	30.6 (777)	34.1 (866)	41.5 (1054)
Overall Depth - in (mm)		30.9 (785)	35.3 (897)	42.3 (1074)	44.7 (1135)	47.1 (1196)
Overall Height - in (mm)		43 (1092)	45 (1143)	47.2 (1199)	49.9 (1267)	57.2 (1453)
Cylinder Diameter - in (mm)		21 (533)	24 (610)	26.3 (668)	30 (762)	36 (916)
Cylinder Depth - in (mm)		13.8 (351)	16 (406)	20.3 (516)	22 (559)	21.9 (556)
Cylinder Volume - cu ft (liters)		2.8 (79)	4.2 (119)	6.3 (178)	9.0 (255)	12.9 (365)
Door Opening Size - in (mm)		11.6 (295)	14.3 (363)	16.3 (414)	16.3 (414)	18.5 (470)
Door Bottom to Floor - in (mm)		14.4 (366)	14 (356)	14.6 (371)	14.9 (378)	17.9 (455)
Water Inlet Connection - in (mm)		2 x 0.75 (19)	2 x 0.75 (19)	2 x 0.75 (19)	4 x .75 (19)	4 x .75 (19)
Drain Diameter - in (mm)		1 x 3 (76)	1 x 3 (76)	1 x 3 (76)	1 x 3 (76)	1 x 3 (76)
Drain Center Height to Floor - in (mm)		3.9 (99)	4.3 (109)	4.5 (114)	4.9 (124)	5.1 (130)
Motor Power - HP (kW)		1 (0.75)	1 (0.75)	2 (1.5)	3 (2.25)	5 (3.75)
Total # of Speeds		6, 9	6, 9	6, 9	6, 9	6, 9
Cylinder Speed RPM (G-Force)	Gentle	37 (0.4)	34 (0.4)	33 (0.4)	31 (0.4)	28 (0.4)
	Wash	51 (0.8)	48 (0.8)	46 (0.8)	43 (0.8)	39 (0.8)
	Distribution	92 (2.5)	86 (2.5)	82 (2.5)	77 (2.5)	70 (2.5)
	Very Low Extract	301 (27)	282 (27)	269 (27)	252 (27)	230 (27)
	Low Extract	518 (80)	485 (80)	464 (80)	434 (80)	396 (80)
	Medium Extract	579 (100)	542 (100)	518 (100)	485 (100)	443 (100)
	High Extract	648 (125)	606 (125)	579 (125)	542 (125)	495 (125)
	Very High Extract	710 (150)	664 (150)	635 (150)	594 (150)	542 (150)
	Ultra High Extract	819 (200)	766 (200)	733 (200)	686 (200)	626 (200)
Voltage/Circuit Breaker FLA	B 120/60/1	15-9	15-12	20-15	N/A	N/A
	X 200-240/50-60/1-3	15-4 (1 Ph) 15-3 (3 Ph)	15-7 (1 Ph) 15-4 (3 Ph)	15-7 (1 Ph) 15-4 (3 Ph)	15-11 (1 Ph) 15-7 (3 Ph)	20-15 (1 Ph) 15-9 (3 Ph)
	N 440-480/50/60/3	15-2	15-3	15-3	15-4	15-6
Shipping Dimensions - in (mm)	Width	28 (711)	31.5 (800)	32.5 (826)	37.5 (953)	44 (1118)
	Depth	33.8 (859)	38.3 (973)	43.5 (1105)	46.9 (1191)	54.5 (1384)
	Height	49.4 (1255)	51.3 (1303)	53.6 (1361)	56.3 (1430)	59.6 (1514)
Net Weight - lb (kg)		340 (154)	440 (200)	540 (245)	680 (308)	1250 (567)
Standard Shipping Weight - lb (kg)		380 (172)	480 (218)	580 (263)	720 (327)	1300 (590)
Slat Crate Shipping Weight - lb (kg)		460 (209)	580 (263)	680 (308)	840 (381)	1430 (649)
Agency Approvals		cULus	cULus	cULus	cULus	cULus

**TO LEARN MORE OR TO FIND A DISTRIBUTOR IN YOUR AREA, VISIT UNIMAC.COM**  
**ALLIANCE LAUNDRY SYSTEMS - SHEPARD ST, RIPON, WI 54971 - 1.800.587.5458**

Consult your UniMac distributor for details. For the most accurate information, the installation guide should be used for all design and construction purposes. Due to continuous product improvements, design and specifications subject to change without notice. The quality management systems at Alliance Laundry Systems are registered to ISO 9001.



5610 McAdam Road, Mississauga, Ontario L4Z 1P1  
 905.890.1220 • 800.387.9503 • Fax: 905.890.7039  
 email: harco@harcoco.com • www.harcoco.com